

VAN-MET® MODEL FCI-150 - Two Hour Fire-Rated Insulated for Wall or Ceiling Application

manufactured to the VAN-MET® design standard

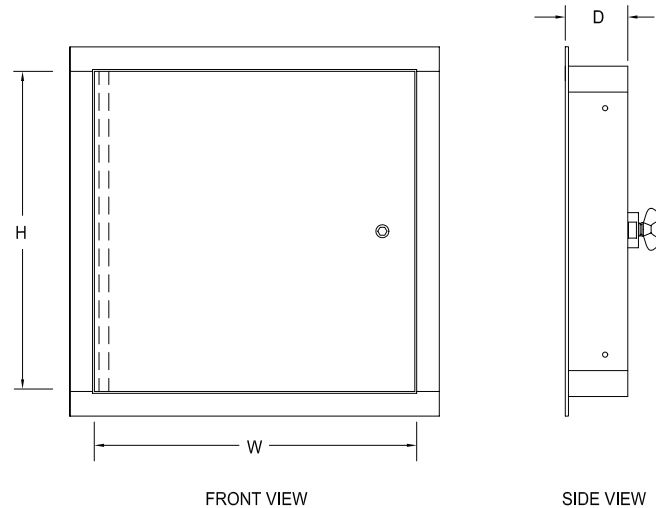

Model FCI-150 wall and ceiling fire-rated panels are manufactured under the factory inspection service of Intertek (Warnock Hersey) and have a label reading: "Listed access frame and insulated fire door assembly **2 hour fire rating. Vertical and Horizontal Installation.** Temperature rise maximum 139° C / 250° F at 30 minutes, 250° C / 450° F at 60 minutes."



- Offers the largest net size openings available, in a two hour fire-rated single leaf panel, making these doors ideal for use when installation or removal of equipment is a consideration.
- Designed for use in a wall or ceiling application where control of temperature rise and heat transmission is required.
- Meets temperature rise requirements for a wall application in the United States at 250° F at 30 minutes and 450° F at 60 minutes. In Canada at 250° C at 60 minutes.
- Insulation helps in reducing sound transmission through the door.
- Largest single leaf sizes in a ceiling application up to 762mm x 1219mm (30" x 48") and 914mm x 914mm (36" x 36").
- Largest single leaf size in a wall application up to 1219mm x 1524mm (48" x 60").
- Optional: Central two point latch operator (phone for details).
- Exterior appearance is compatible with the non-rated and fire-rated Van-Met access door line.

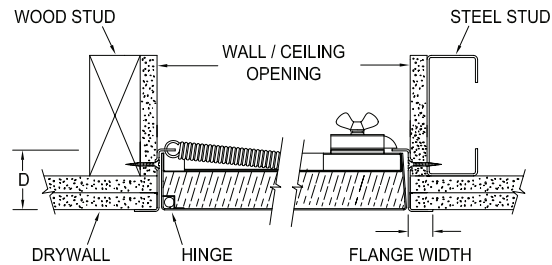

Materials

Satin finish galvanized steel or 304 stainless steel
 Frame - 1.61mm (16ga) steel up to and including 762mm x 1219mm (30" x 48")
 Frame - 1.99mm (14ga) steel greater than 762mm x 1219mm (30" x 48")
 Panel - 1.31mm (18ga)
 Liner - 0.85mm (22ga)

Insulation

The door panel contains 38mm (1 1/2") of high temperature insulation material between a 1.31mm (18ga) steel panel and a 0.85mm (22ga) steel liner.

Non-Combustibility Classification:

CAN/ULC S114, ASTM E136
 CAN/ULC S102
 ASTM E84, UL723
 Flame Spread 0
 Fuel Contribution 0
 Smoke Developed 0

Finishes

The paint finish is an electrostatically applied rust inhibitive prime coat or a No. 4 polished stainless steel finish on the exterior surface.

Hinges

The concealed continuous rod hinge is designed to secure the door panel. The hinge is placed on the long side of the door ("H" dimension) unless otherwise requested.

Optional Hinge

Continuous piano hinge
Note: Greater than 1219mm (48") in a wall position a continuous piano hinge is standard.

Panel Closer

The automatic panel closer will close and latch the door from an open position of approximately 90° as required by code.

All Van-Met® fire-rated access doors are manufactured to this criteria and do not require any auxiliary springs.

Latch

The standard factory installed latch is a flush mount 1/4" allen key. All fire-rated locks are self-latching and include an interior latch release mechanism allowing the doors to be opened from the inside. The interior latch release is standard on doors including and exceeding 406mm x 406mm (16" x 16"). Under 406mm x 406mm (16" x 16") by request only.

Optional Latches

Raised knurled knob
 Non-locking handle

Optional Lock

1 1/8" mortise prep complete with mortise cylinder

Optional

1 1/8" mortise prep only
 Locking "T" handle (Door inoperable from inside.)

Flange

Exterior flange
 Width - 22mm (7/8") up to and including 914mm x 914mm (36" x 36")
 Width - 32mm (1 1/4") when greater than 914mm x 914mm (36" x 36")

Frame Depth

"D" = 57mm (2 1/4")

Ordering

When ordering, please specify wall or ceiling application.
 Please order by rough opening size.

Installation

The frame is manufactured with mounting holes. Factory installed anchor straps are available for masonry, upon request.

See size and weight chart on page 45.