



MAXAM
METAL PRODUCTS

5 7978 North Fraser Way
Burnaby, B.C. V5J 0C7
Tel: 604 433 4243
Fax: 604 433 4148
E-mail: info@maxammetal.com

VAN-MET[®] MODEL FCI-600
THREE HOUR FIRE-RATED ACCESS DOOR
High Temperature, Insulated, Wall Application

Offers best temperature rise available.

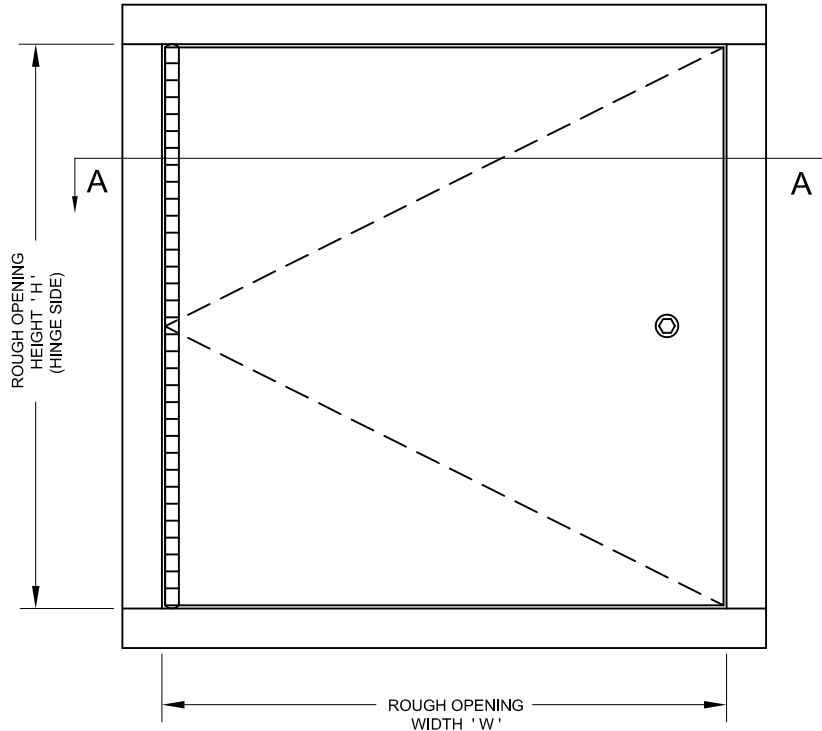

FRONT ELEVATION

STANDARD CONSTRUCTION:

- MATERIAL** - SATIN FINISH GALVANIZED (GALVANNEALED) STEEL.
- PANEL** - 1.31mm [18 ga] , SELF CLOSING.
- LINER** - 0.85mm [22ga].
- FRAME** - 1.61mm [16 ga] UP TO 762mm x 1219mm [30" x 48"]. LARGER SIZES: 1.99mm [14ga].
- FLANGE** - 22mm [$\frac{7}{8}$ "] EXTERIOR FLANGE UP TO AND INCLUDING 914mm x 914mm [36" x 36"]. LARGER SIZES: 32mm [1 $\frac{1}{4}$ "].
- HINGE** - CONTINUOUS PIANO HINGE.
- PANEL CLOSER** - THE AUTOMATIC PANEL CLOSER WILL CLOSE AND LATCH THE DOOR FROM AN OPEN POSITION OF APPROXIMATELY 90° AS REQUIRED BY CODE.
- LATCH** - $\frac{1}{4}$ " ALLEN KEY, WITH INTERIOR RELEASE.

INSULATION - 152mm [6"] HIGH TEMPERATURE

FINISH - RUST INHIBITIVE PRIME COAT (OFF-WHITE).

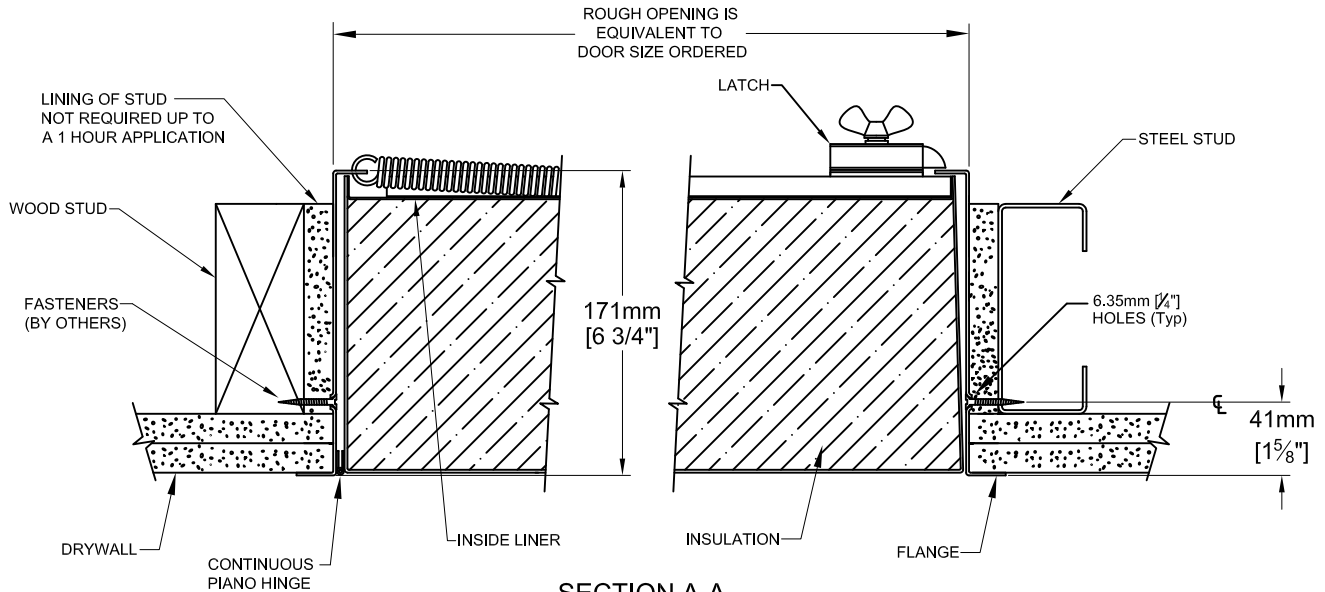

SECTION A-A

* Specifications subject to change without notice.

PROJECT: _____

CONTRACTOR: _____

ARCH. OR ENG.: _____

DATE: _____

Revised 08/08/16

These drawings are the property of Maxam Metal Products Ltd. and incorporates information which is proprietary. Publication and/or public distribution in whole or in part is expressly prohibited without the prior written consent of Maxam Metal Products Ltd. The information herein remains the property of Maxam Metal Products Ltd. All rights reserved.

DWN BY KB	DATE Feb. / 2014	DWG. NO. Sheet 1 of 2	REV.
--------------	---------------------	--------------------------	----------

INSTALLATION:

The frame is manufactured with mounting holes. All holes must be securely fastened on all four sides. See installation instructions supplied with panel.

WARRANTY:

One Year Limited warranty. For complete details see **Access Door** warranty document.

ORDERING:

- PLEASE ORDER BY ROUGH OPENING SIZE.
- WHEN ORDERING THE SECOND DIMENSION GIVEN IS THE HINGE SIDE. (ie. 457mm x 610mm [18" x 24"], THE 610mm [24"] DIMENSION IS THE HINGE SIDE.
- **THESE DOORS ARE NON-RETURNABLE.**



Model FCI-600 fire-rated panels are manufactured under the factory inspection service of Intertek (Warnock Hersey) and have a label reading: "Listed access frame and insulated fire door assembly **3 hour fire rating. Vertical Installation** ." Temperature rise maximum 20°C / 36°F at 30 minutes, 40°C / 72°F at 60 minutes, 50°C / 90°F at 90 minutes, 60°C / 108°F at 120 minutes."

STANDARD SIZES

FCI-600, insulated for Wall Applications - Opens 180°

Rough Opening Size W x H		Net Opening Size W x H		No. of Latches	Weight in kgs.	Weight in lbs.
Metric (mm)	Inches	Metric (mm)	Inches			
457 x 457	18 x 18	349 x 419	13 ³ / ₄ " x 16 ¹ / ₂ "	1	17.80	39.00
610 x 610	24 x 24	521 x 572	20 ¹ / ₂ " x 22 ¹ / ₂ "	1	26.00	57.00
762 x 762	30 x 30	686 x 724	27" x 28 ¹ / ₂ "	1	35.70	79.00
914 x 914	36 x 36	845 x 876	33 ³ / ₄ " x 34 ¹ / ₂ "	2	42.20	104.00
1219 x 1219	48 x 48	1156 x 1181	45 ¹ / ₂ " x 46 ¹ / ₂ "	2	73.50	162.00
1219 x 1524	48 x 60	1156 x 1486	45 ¹ / ₂ " x 58 ¹ / ₂ "	2	88.30	194.00

Hinge Side

- Note :
- Width of door cannot exceed 1219mm [48"] in a single leaf door.
 - Other sizes available upon request for all models.

PROJECT - millimeters
SCHEDULE - inches

Qty	Rough Opening Size	
	Width	Height

Hinge Side

PROJECT: _____
CONTRACTOR: _____
ARCH. OR ENG.: _____
DATE: _____

PURCHASE ORDER: _____
APPROVED BY: _____