

VAN-MET® MODEL FRM - Two Hour Fire-Rated Uninsulated for Wall Application

manufactured to the **Van-Met®** design standard

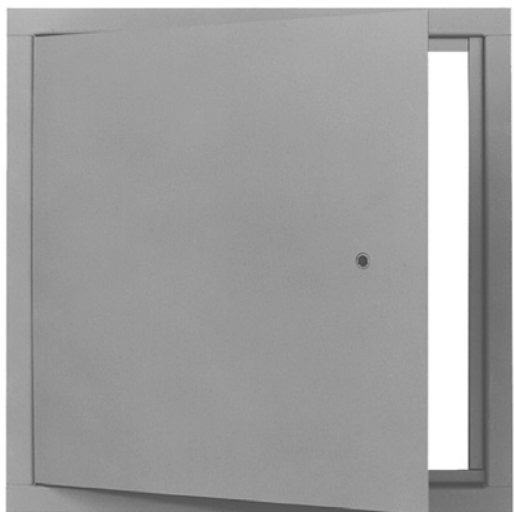

Model FRM is designed to maintain the continuity of a fire barrier when installed in a **Vertical Separation**. The assembly is manufactured under the factory inspection service of Intertek (Warnock Hersey) and has a label reading: "Listed access frame and fire door assembly. **2 hour fire rating**. Vertical installation only. No temperature rise rating."

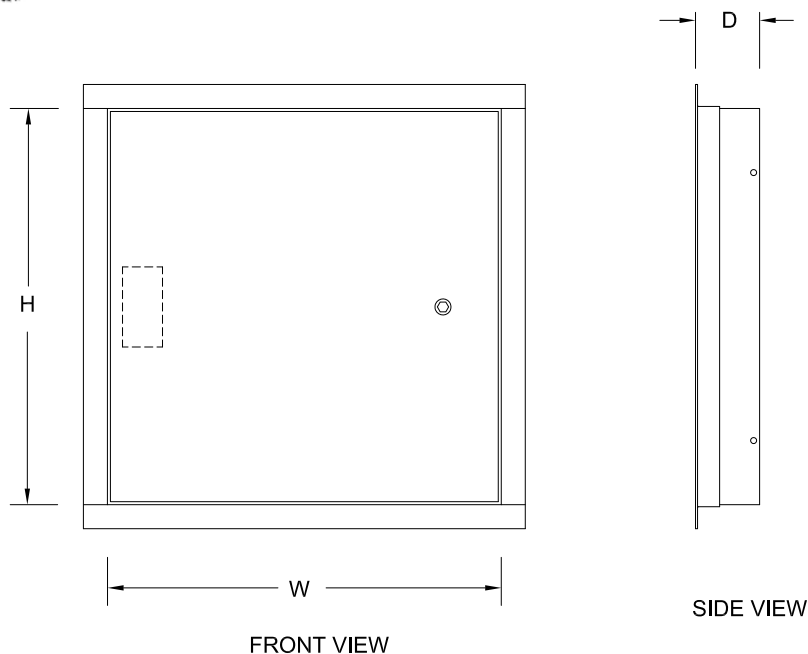

- This sturdy versatile panel is designed for installation in all types of building materials and is ideal for new construction or remodeling work.
- Install after the finishing materials have been applied. Simply frame in, cut rough opening and install.
- Exterior flange conceals the edges of the rough opening for an attractive appearance.
- Van-Met concealed zinc plated spring hinges allow panel to open 175° for easy access.
- Available in any size from 152mm x 152mm (6" x 6") up to 1219mm x 1524mm (48" x 60").
- Exterior appearance is compatible with the non-rated and fire-rated Van-Met access door line, so uniformity of design is maintained when the doors are installed in the same building.

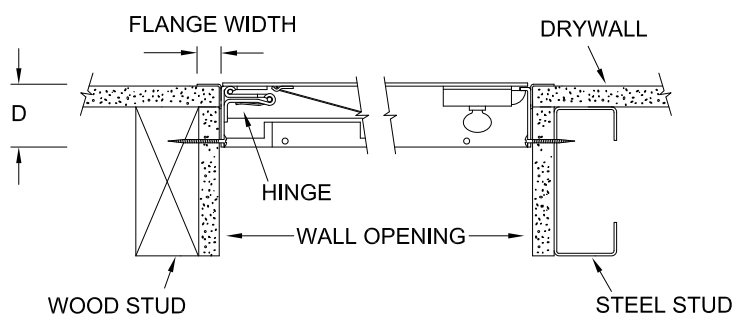

Available in stock sizes or made to your specifications.

Materials

Satin finish galvanized steel or 304 stainless steel
 Frame – 1.61mm (16ga)
 Panel – 1.99mm (14ga)

Finishes

The paint finish is a rust inhibitive off-white prime coat or a No. 4 polished stainless steel finish on the exterior surface.

Hinge

The Van-Met concealed zinc plated spring hinges allow the door panel to open 175°. Number of hinges varies with the size of door, and the placement of the hinge is on the long side of the door ("H" dimension) unless otherwise requested.

Panel Closer

The automatic panel closer will close and latch the door from an open position of approximately 90° as required by code.

Latch

The standard factory installed latch is a flush mount 1/4" allen key. All fire rated locks are self-latching and include an interior latch release.

Optional Latch

Raised knurled knob

Optional Lock

1 1/8" mortise prep complete with mortise cylinder

Optional

1 1/8" mortise prep only

Exterior flange

Width - 19mm (3/4") up to and including 914mm x 914mm (36" x 36")
 Width - 32mm (1 1/4") when greater than 914mm x 914mm (36" x 36")

Frame Depth

"D" = 51mm (2")

Ordering

Please order by rough opening size.

Installation

The frame is manufactured with mounting holes. Factory installed anchor straps are available for masonry upon request.

Flange