

VAN-MET® FIRE-RATED ACCESS DOOR
MODEL FCB-250 – THREE HOUR, INSULATED FOR WALL OR CEILING APPLICATION

SPECIFICATIONS

- MATERIAL:** SATIN FINISH GALVANIZED (BONDERIZED) STEEL
PANEL: 1.31 mm (18ga), SELF-CLOSING
LINER: 0.85 mm (22ga)
FRAME: 1.61 mm (16ga)
FLANGE: GALVANIZED STEEL DRYWALL BEAD TAPING FLANGE
HINGE: CONTINUOUS ROD HINGE
LATCH: 1/4" ALLEN KEY, WITH INTERIOR RELEASE
INSULATION: 63mm (2 1/2") HIGH TEMPERATURE
FINISH: PRIME COAT, OFF-WHITE

OPTIONS (CHECK OFF REQUIRED OPTIONS)

- RAISED KNURLED KNOB
- NON-LOCKING HANDLE
- 1 1/8" MORTISE PREP ONLY
 - CYLINDER PROVIDED BY MAXAM
 - CYLINDER PROVIDED BY OTHERS
- CONTINUOUS PIANO HINGE
- 304 STAINLESS STEEL WITH A NO. 4 POLISHED FINISH ON THE EXTERIOR SURFACE

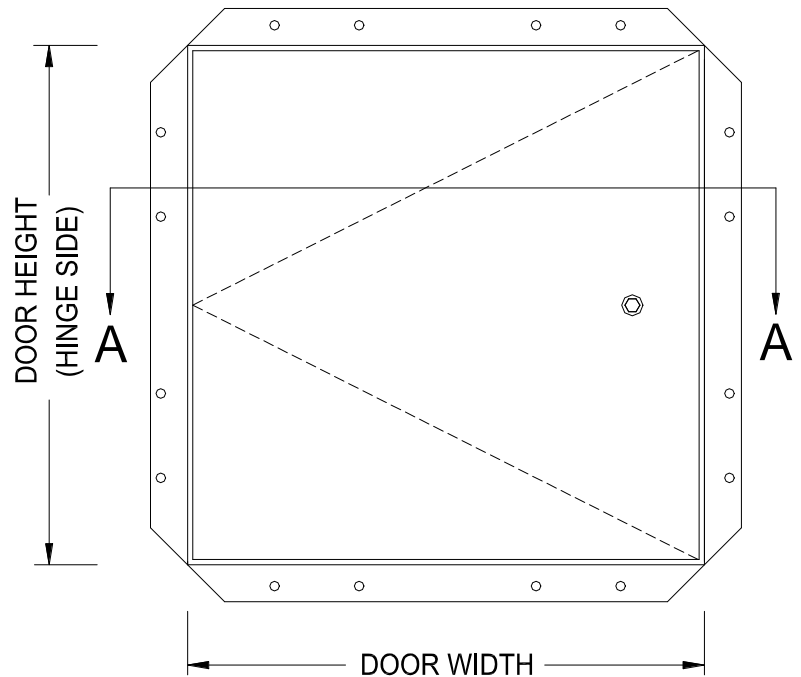

FRONT ELEVATION



WARNOCK HERSEY LISTED FOR 2 HOUR WALLS; ① TEMPERATURE RISE MAXIMUM 139°C / 250°F AT 30 MINUTES, ② 250°C / 450°F AT 60 MINUTES
 ③ WARNOCK HERSEY LISTED FOR 3 HOUR CEILING.

- ① & ② UNITED STATES BUILDING CODE
- ② NATIONAL BUILDING CODE OF CANADA
- ③ LISTED FOR UNITED STATES AND CANADA

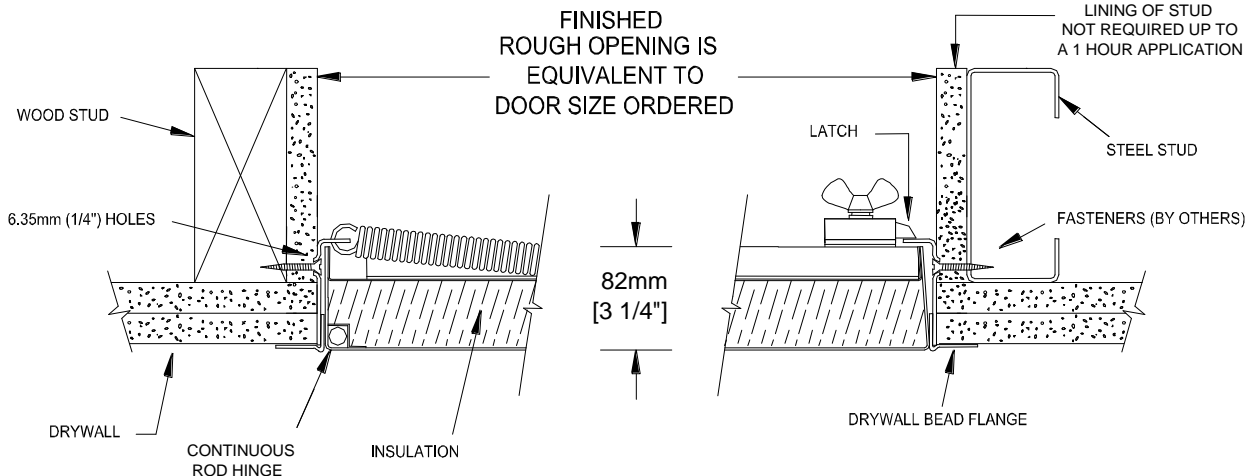

SECTION A-A



Maxam Metal Products Ltd.
 Unit 5 – 7978 North Fraser Way
 Burnaby, BC, Canada V5J 0C7

Tel: 604-433-4243
 Fax: 604-433-4148

Website: www.maxammetal.com
 Email: info@maxammetal.com

PROJECT:			
CONTRACTOR:			
ARCHITECT:			
DRAWN BY: KJK	DATE: 01/01/2003	QUANTITY:	TITLE: FCB-150.DWG

* Specifications subject to change without notice.